

# THE SUMMIT PAVILION

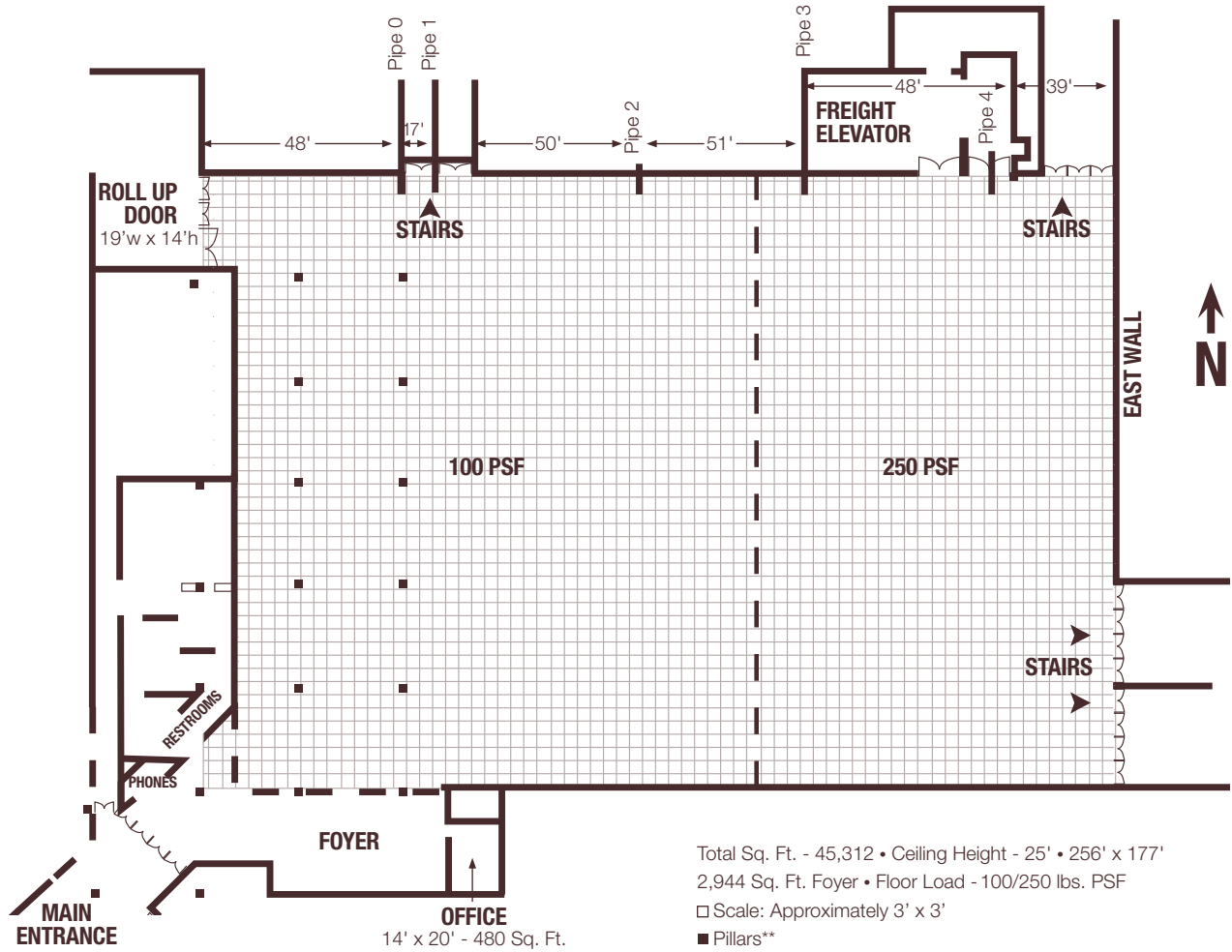

Room Capacities\*

	THEATRE	CLASSROOM	BANQUET	RECEPTION	10' x 10' EXHIBIT
<b>THE SUMMIT PAVILION</b>	4,000	1,700	2,140	4,000	265
<b>SUMMIT E (EWALL-PIPE 3)</b>	1,200	900	1,070	1,200	90
<b>SUMMIT CTR (PIPE 2-PIPE 4)</b>	1,600	1,080	1,120	1,600	98
<b>SUMMIT W (PIPE 1-PIPE 3)</b>	1,900	1,260	1,400	1,900	140

\* Capacity figures are subject to change, depending on space allocations for head table, dance floor, staging and catering requirements.

\*\* Pillars may obstruct view in some configurations.

**SOUND:** Altec coaxial ceiling speakers.

**LIGHTING:** Dimmable ceiling track system.

**POWER:** Five 400 amp 208 volt 3 phase disconnect boxes. Complete ceiling track system with 20 amp 208 volt 3 phase service. Fifty-five 30 amp 208 volt 3 phase floor pockets with 20 amp 110 volt dedicated circuit.

Accommodates 265 - 10' x 10' Booths • 310 - 8' x 10' Booths



**GRAND SIERRA**  
RESORT AND CASINO